

# CDM6240

Single banknote dispenser with large capacity and high speed

## Product features

- Compliant with financial industrial standard
- Banknote detection and handling technique
- Low operation and maintenance cost
- Friendly maintenance



High bill dispensing speed of 4notes/s provides good user experience . Impact-resistant cassettes with large capacity lower the frequency of cash loading . High-grade note detection technology ensures accurate transaction data . All above embody our design concept of high reliability and friendly maintenance , which decrease the cost for operation and maintenance . CDM 6240 will surely meet your application demands .



Metro



Bank



Amusement park

# CDM6240

## Single banknote dispenser

### Performance

#### Reliability

- Complete detection for worn bills, double bills and folded bills
- Available to banknotes of various materials and various levels of oldness
- Electronic tag on the cassette supports status record and inquiry
- Keyed reject bin is fully enclosed for security.

#### Efficiency

- Cassette with the large capacity of 2000 notes lowers the frequency of cash loading and decreases maintenance cost
- Dispensing speed: 4 notes per second

#### Friendly Maintenance

- Less quick-wear parts and longer service life
- Solve bill jams in need of no professional tools

#### Outline Dimension Drawing (Unit: mm)

CDM6240 has 1 cassette as standard configuration. The number of cassettes can be up to 3, with total height increased by 142.5mm for each cassette.

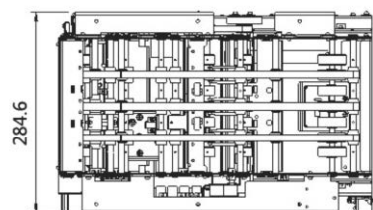
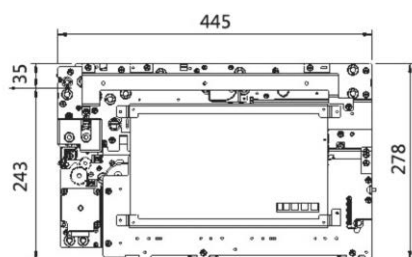

### Specifications

#### Bill Dispensing

- Single widthwise with a speed of 4 notes per second

#### Banknote Available

- Material : paper and polymer
- Length range:110~172mm
- Width range:55~85mm ,
- Thickness range: 0.06~0.18mm

#### Cassette

- Capacity : 2000 notes for each cassette
- Low level detection: 50~250 notes
- Equipped with magnetic ID( RFID optional)

#### Reject Bin

- Capacity : 100 notes
- Fully enclosed and isolated design with a security lock

#### Maintenance Direction

- Front/ rear access

#### Power Supply

- DC 24V±10% , 50W ( maximum )

#### Communication Interface

- RS-232 or USB

#### Weight

- 18.9kg ( standard configuration, with one cassette )
- Total weight increases by 9.9 kg for adding each cassette

#### Environment

- Working temperature: 0°C~50°C
- Working humidity: 20%~90%RH

#### MCBF

- 100,000 cycles



Design with high reliability



Easy solution of bill jams



Off-line trouble-shooting

Note : In case the specifications be upgraded, you may as well contact with us to get the latest information. The picture shall be taken as a reference. The product appearance depends on goods.

GRG Banking Equipment Co., Ltd.

Address: 9 Kelin Road, Luogang District, Guangzhou, China 510663

Sales TEL: (020) 8218 8622 FAX: (020) 8218 8516

E-mail: afc@grgbanking.com

7x24service

Service TEL



400-700-2468